

Rear road spring - To remove RH9929INS

- 1.) Drive the car on to a ramp and chock the front wheels.
- 2.) Move the gear range selector lever to the park position.
- 3.) Support the final drive unit with a jack.
- 4.) Insert spring retention tool RH 9299 through the centre of the lower spring support. Screw the tool fully into the upper spring support.
- 5.) Lift the rear of the car until the suspension is in the full rebound position. Position sill blocks beneath the car sills to support the body.
- 6.) Carefully manoeuvre the spring from its seat and remove it from between the trailing arm and the body.
- 7.) Remove the spring seats and adjusting rings from the spring.

Note:

On Corniche III and Continental cars conforming to a Canadian, Middle East, and USA specification an additional spacer and seat are fitted beneath the normal spring seat and adjusting rings (see fig.

H11-1

- 8.) Remove the two dowels from the baseplate of the spring compression tool RH 7909 and fit adapter block RH 9504.
- 9.) Position the compressed spring into the compression tool with the upper spring support in the adapter block (see fig.

H11-3

H11-3).

- 10. Fit the top plate of the tool. Screw down the special nuts and thrust washers to secure the spring.
- 11. Measure and record the distance between the upper and lower plates.
- 12. Remove the spring retention tool RH 9299.

Ensure that the threads in the upper spring support are in good condition to withstand the full spring load when the retention tool is inserted.

- 13. Evenly unscrew the two nuts on the compression tool to completely extend the spring.
- 14. Examine all the components for serviceability.

Fig. H11-1

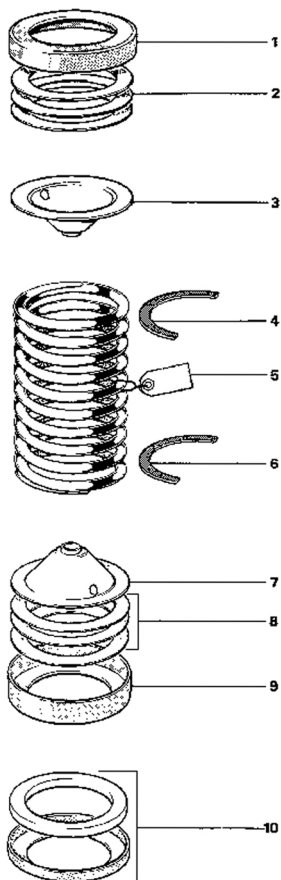

A3306

1	Pliable spring seat
2	Adjusting rings (as required)
3	Upper spring support (threaded centre)
4	Flexible strip
5	Spring loading label
6	Flexible strip
7	Lower spring support
8	Adjusting rings (as required)
9	Pliable spring seat
10	Special 8,89 mm (0.350 in) thick spacer and shortened, pliable seat (Only fitted to Corniche III and Continental cars conforming to a Canadian, Middle East, and USA specification)

Fig. H11-3

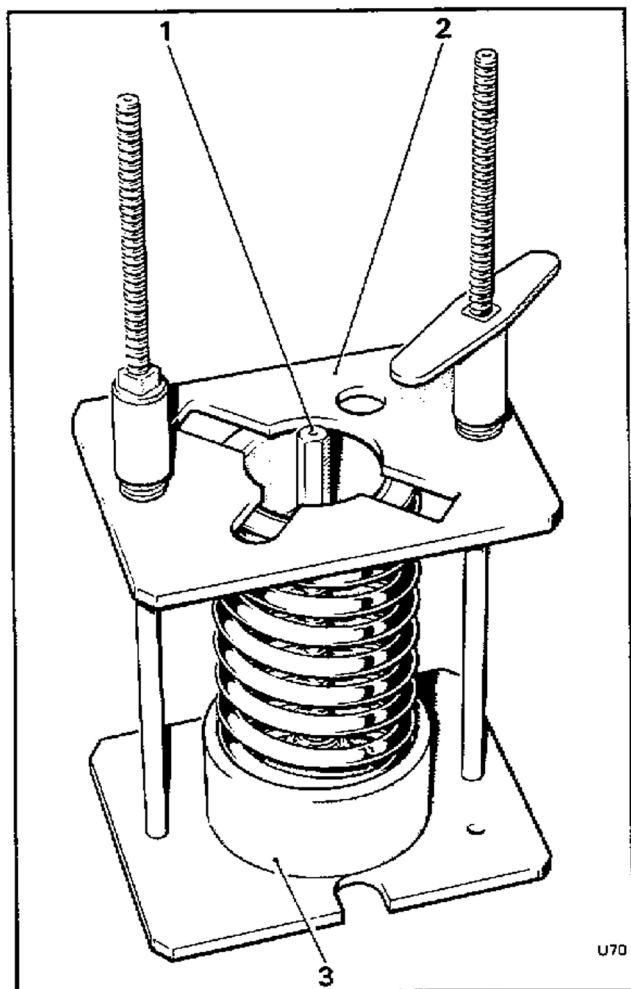

1	Tool RH 9299 and thrust washer
2	Tool RH 7909
3	Adapter block RH 9504